

**AERODROME GROUND
MOVEMENT CHART - ICAO**

CENTRAL APRON ELEV **16 m**
THE OTHER APRON ELEV **13 m**

| | | | |
|-----|---------|---------|---------|
| TWR | 118.05 | 118.1 | 240.9 |
| GND | 121.9 | 121.95 | |
| APN | 129.525 | 130.875 | 131.175 |

SEOUL / Gimpo INTL
RWY 14L/32R
RWY 14R/32L DEPARTURE

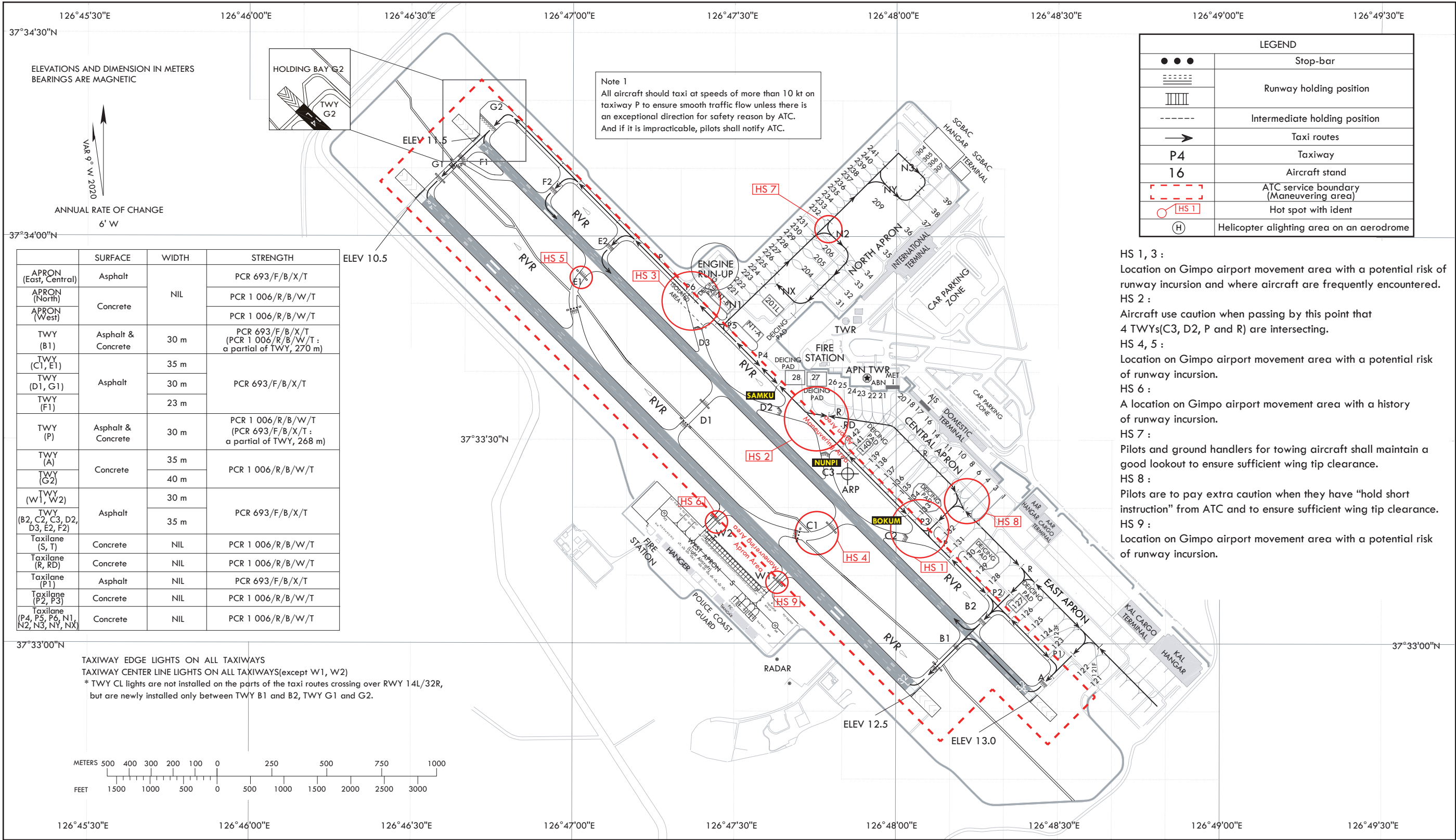

Change : Information of west apron and Amended taxi route.

AERODROME GROUND MOVEMENT CHART - ICAO

CENTRAL APRON ELEV **16 m**
THE OTHER APRON ELEV **13 m**

| | | | |
|-----|---------|---------|---------|
| TWR | 118.05 | 118.1 | 240.9 |
| GND | 121.9 | 121.95 | |
| APN | 129.525 | 130.875 | 131.175 |

SEOUL / Gimpo INTL
RWY 14L/32R
RWY 14R/32L ARRIVAL

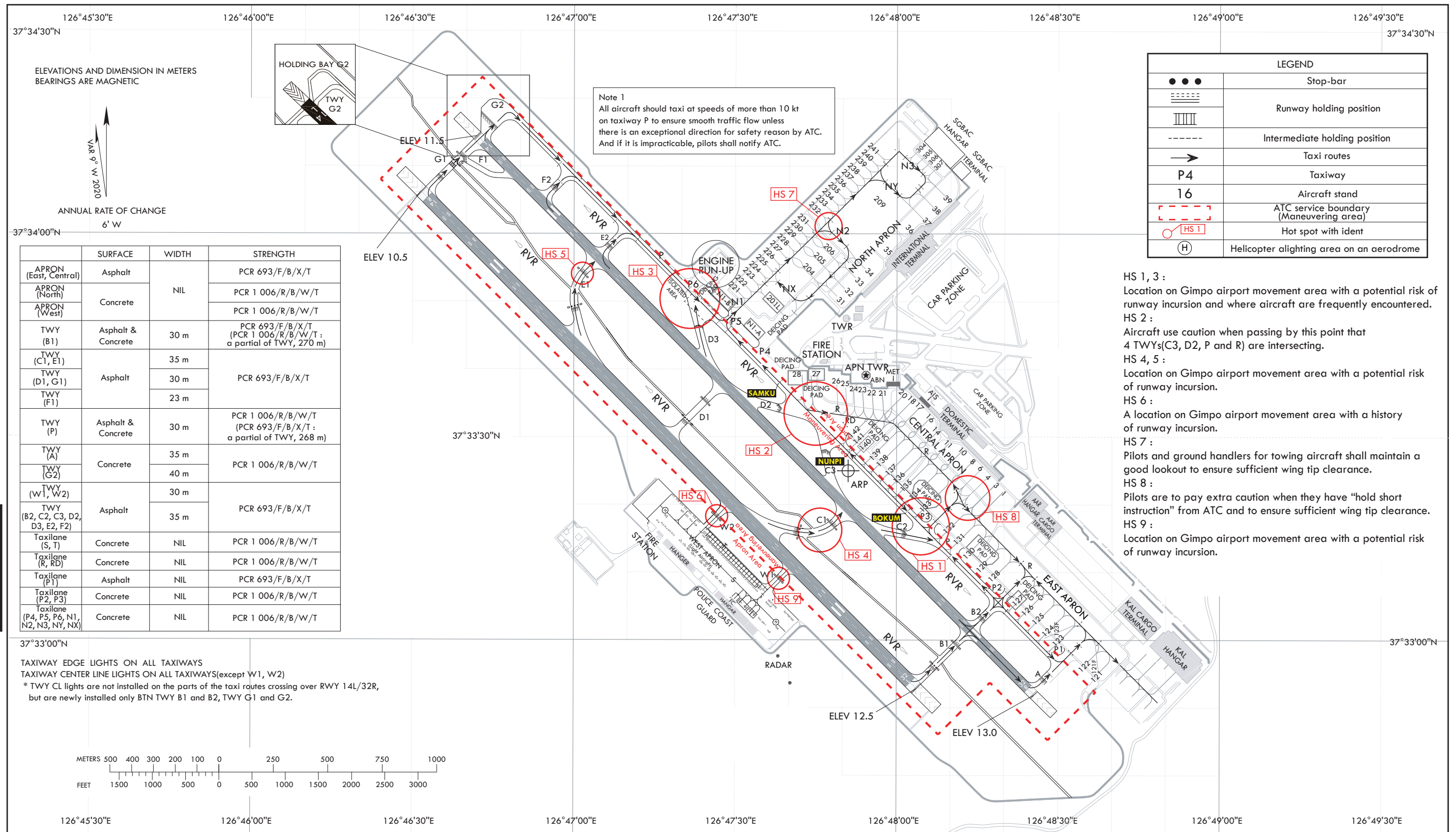

OFFICE OF CIVIL AVIATION

AIRAC AIP AMDT 6/25
Effective : 1600UTC 9 JUL 2025