

TEL : 82-53-668-0284
FAX : 82-53-668-0277
AFS : RKRRYNYX
E-mail : aisd@korea.kr
Web : <https://aim.koca.go.kr>

REPUBLIC OF KOREA
Ministry of Land, Infrastructure and Transport
Office of Civil Aviation
11, Doum 6-ro, Sejong-si, 30103, Republic of Korea

AIRAC
AIP
Supplement 17/23
29 JUN 2023

GEN : NIL

ENR : NIL

A D : SEOUL/Incheon INTL(RKSI)

RWY 15L/33R AND TWYs CLOSED DUE TO CONSTRUCTION

1. INTRODUCTION

- (1) RWY 15L/33R will be closed due to pavement construction.
- (2) Some parts of TWY C and TWY D will be closed due to pavement construction.
- (3) TXL R17 will be closed due to pavement construction.

2. CLOSED AREAS & PERIOD (See the diagram)

Closed Areas		Period(UTC)
A	RWY 15L/33R between TWY J and K ※ No effect on TWY J and K operation.	From 1600 UTC 9 AUG 2023 To 1600 UTC 31 MAR 2024
	TWY C between TWY J and K	
	Rapid exit TWY C1, C2, C4, C5	
	Rapid exit TWY D1, D6	
B	RWY 15L/33R below TWY J	From 1600 UTC 9 AUG 2023 To 1600 UTC 31 MAR 2024
	TWY G between TWY C and D ※ No effect on TWY G between TWY A and C operation.	
	TWY D below TWY J	
C	TXL R17 between TXL R4 and TWY A	From 1600 UTC 9 AUG 2023 To 1600 UTC 1 NOV 2023
	TWY A between TWY A16 and TWY R17 ※ No effect on TWY A16 operation.	

3. REMARKS

- (1) RWY 15L/33R and TWYs will be closed as shown in the diagrams.
- (2) Unserviceability lights and frangible barriers will be installed on the closed area.
- (3) All lights including RWY center line lights, RWY edge lights, RWY touchdown lights, Approach lighting system for RWY 15L/33R will be unserviceable.
- (4) Some parts of standard taxi routes(AIP RKSJ AD CHART 2-6, 2-7, 2-8, 2-9) and low visibility procedures (AIP RKSJ AD 2-29, 2-30, 2-31, 2-32) will be temporarily changed due to the construction.
- (5) Temporary taxi routes may be changed by the ATC instruction.
- (6) TWY center line lights, TWY edge lights, Stop bar lights and TWY guidance sign for the closed area will not be operated.
- (7) Works by equipment and vehicles will be conducted in the working area as shown in the diagrams.
- (8) Any change to the contents of these pages will be notified by NOTAM.

4. DIAGRAMS

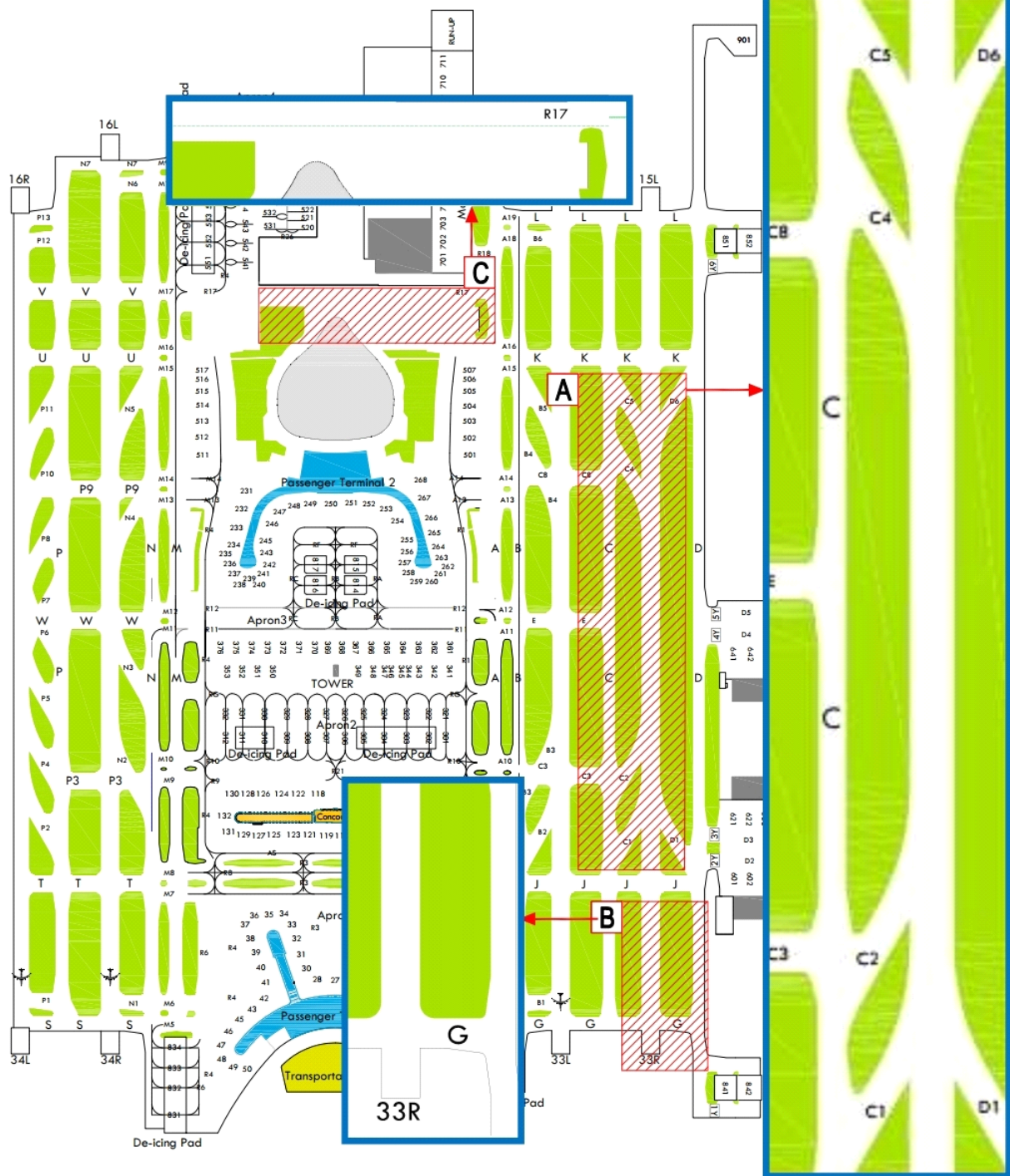

Temporary Taxi Routes (AIP RKSI AD CHART 2-7, 2-9)

Arrival for RWY 15L/R, 16L/R

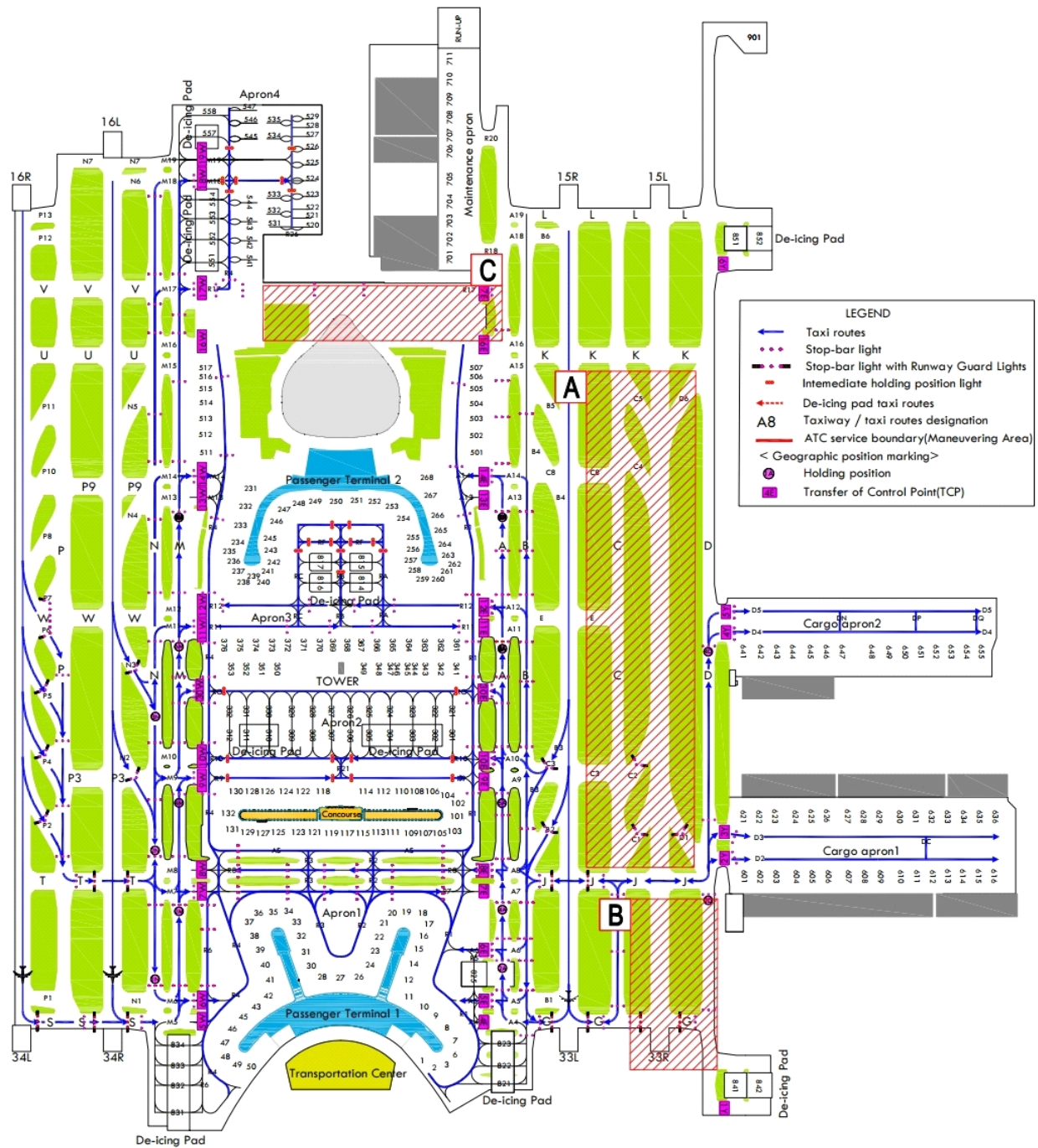

(AIP RKS I AD CHART 2-6, 2-8 and AD 2-32)

The diagram illustrates the layout of an airport, including runways, taxiways, aprons, and terminal buildings. Key features include:

- Runways:** 16L, 16R, 15R, 15L, 34L, 34R.
- Aprons:** Apron 1, Apron 2, Apron 3, Apron 4.
- Terminals:** Passenger Terminal 1, Passenger Terminal 2.
- Other Areas:** Cargo apron 1, Cargo apron 2, Deicing Pad, Maintenance apron, Tower, Transportation Center.
- Legend:**
 - Taxi routes (blue line with arrows)
 - Stop-bar light (red dashed line with a bar)
 - Stop-bar light with Runway Guard Lights (red dashed line with a bar and lights)
 - Intermediate holding position light (red dashed line with a bar)
 - Deicing pad taxi routes (red line with arrows)
 - A8 Taxiway / taxi routes designation (red line with 'A8')
 - ATC service boundary (Maneuvering Area) (red dashed line)
 - Geographic position marking (red line with a bar)
 - Holding position (red line with a bar and lights)
 - Transfer of Control Point (TCP) (red line with a bar and lights)
- Scale:** 1:10,000

Temporary Taxi Routes (AIP RKSI AD CHART 2-7, 2-9)

Arrival for RWY 33L/R, 34L/R

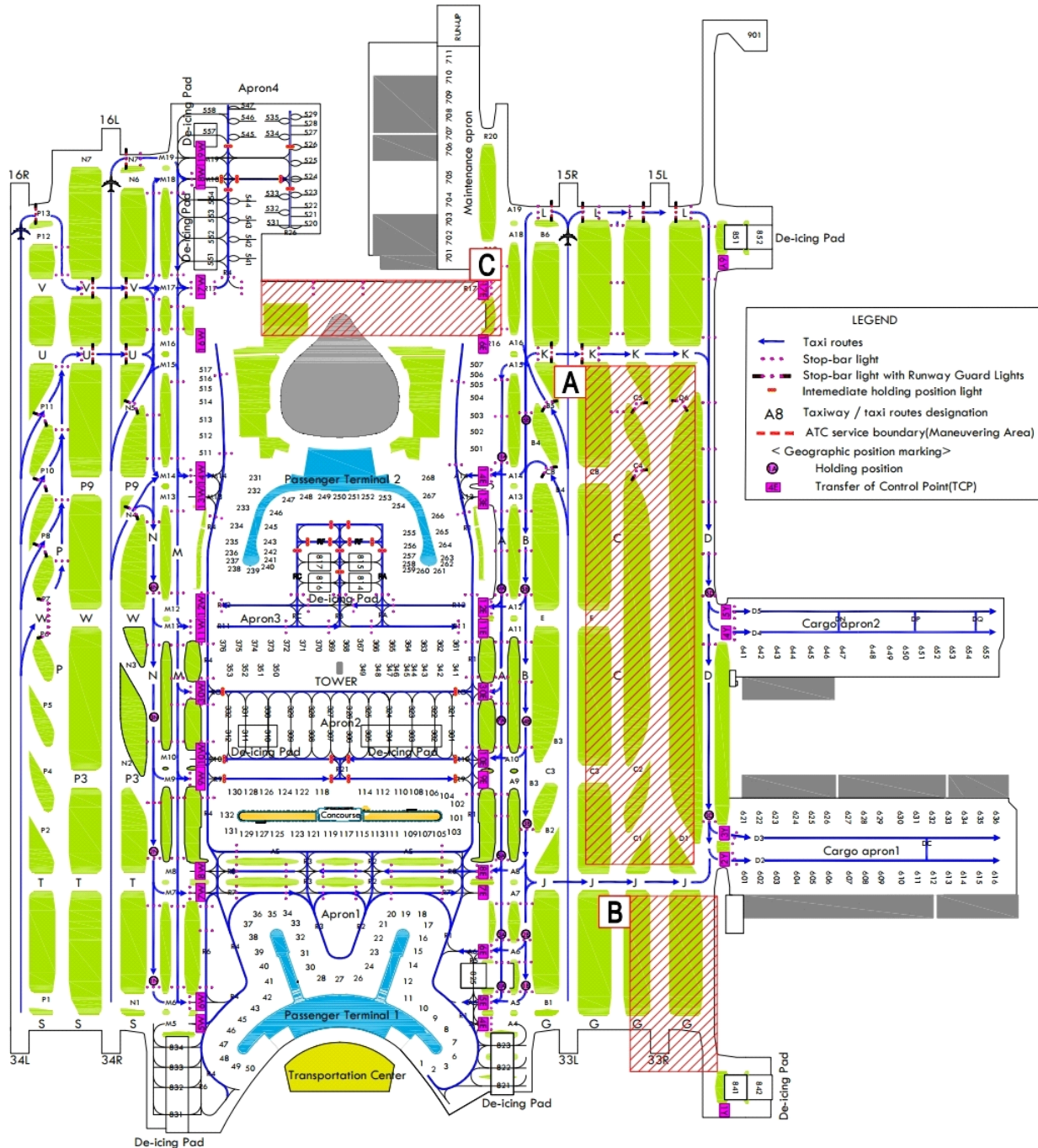

Temporary Taxi Routes (AIP RKSI AD CHART 2-6, 2-8 and AD 2-31)

Departure for RWY 33L/R, 34L/R

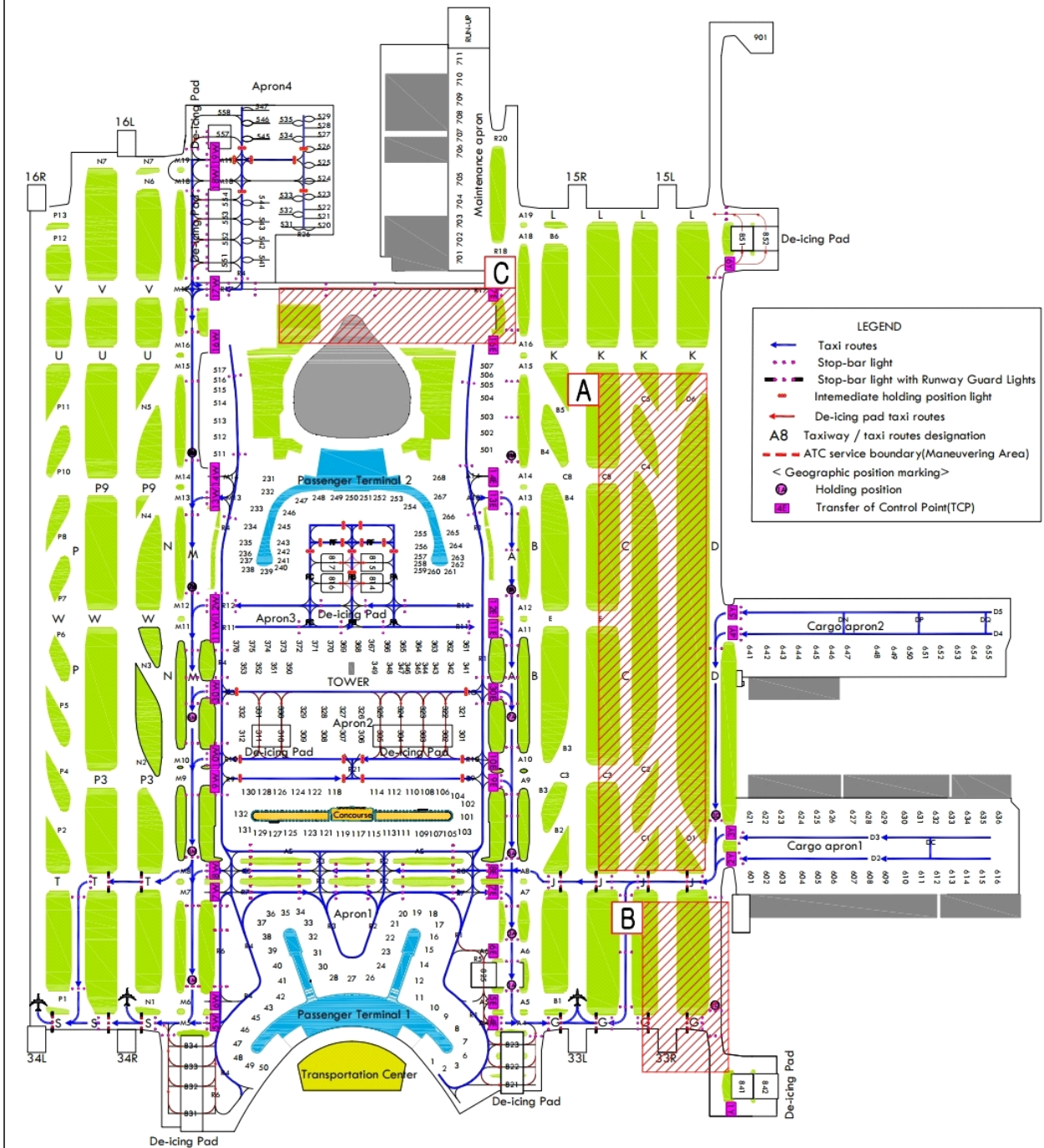

Temporary Taxi Routes

(AIP RKSI AD 2-30)

SMGCS - Arrival for RWY 33L/R, 34L

