

TEL : 82-32-880-0256
FAX : 82-32-889-5905
AFS : RKRRYNYX
E-mail : aisd@molit.go.kr
Web : <http://ais.casa.go.kr>

REPUBLIC OF KOREA
Ministry of Land, Infrastructure and Transport
Office of Civil Aviation
11, Doum 6-ro, Sejong-si, 30103, Republic of Korea

AIP
Supplement 21/20
22 OCT 2020

GEN : NIL

ENR : NIL

A D : SEOUL/Incheon INTL(RKSI)

TWY CLOSED DUE TO APRON CONSTRUCTION

1. INTRODUCTION

Parts of TWY M and TWY R4 will be closed due to apron construction.

2. PERIOD

From 1600 UTC 21 OCT 2020 To 1400 UTC 14 DEC 2020

3. CLOSED AREAS (See the diagram)

Closed Areas	
A	TWY M between M10 and M11 ※ No effect on TWY M10, M11 operation
	TWY R4 between R10 and R11 ※ No effect on TWY R10, R11 operation
B	TWY M between M8 and M9 ※ No effect on TWY M8 operation
	TWY R4 between R8 and R9 ※ No effect on TWY R8 operation
	TWY M9 between M and R4
	TWY R9 between R4 and ACFT stand NR. 130

4. REMARKS

- (1) TWYs will be closed as shown in the diagram.
- (2) Some parts of standard taxi routes(AIP RKSI AD CHART 2-6, 2-7, 2-8, 2-9) and low visibility procedure (AIP RKSI AD 2-29, 2-30, 2-31, 2-32) will be temporarily changed due to the construction.
- (3) If unable to vacate the first rapid exit TWY(N3 and N5), pilot shall notify ATC as early as possible due to ground movement flow.
- (4) Standard taxi routes of the closed area will be changed by the ATC instruction.
- (5) Works by equipment and vehicles will be conducted in the working area as shown in the diagram.
- (6) Any change to the contents of these pages will be notified by NOTAM.

(AIP SUP 2/20 is hereby superseded)

5. DIAGRAM

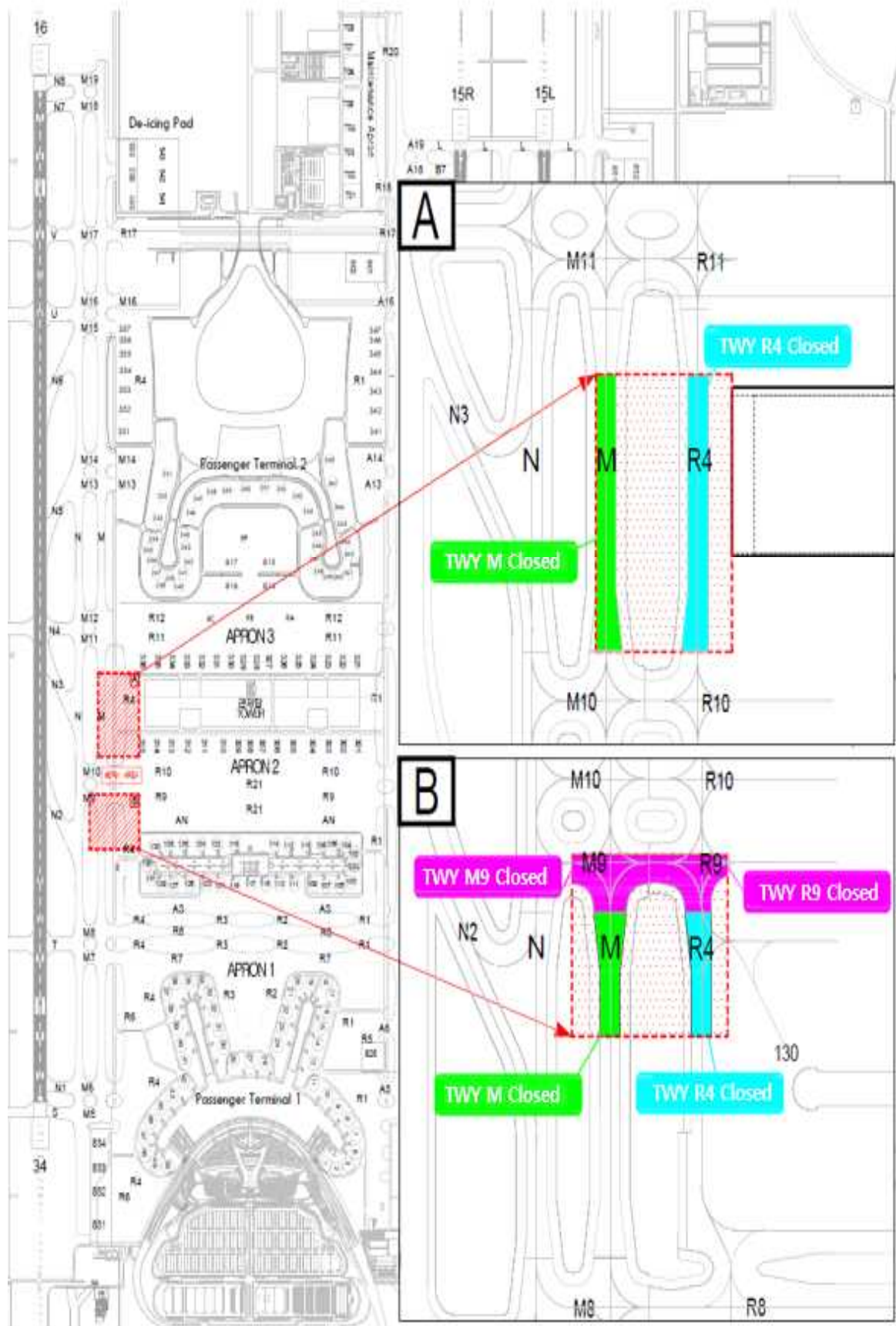

Temporary Taxi Routes

Arrival for RWY 16

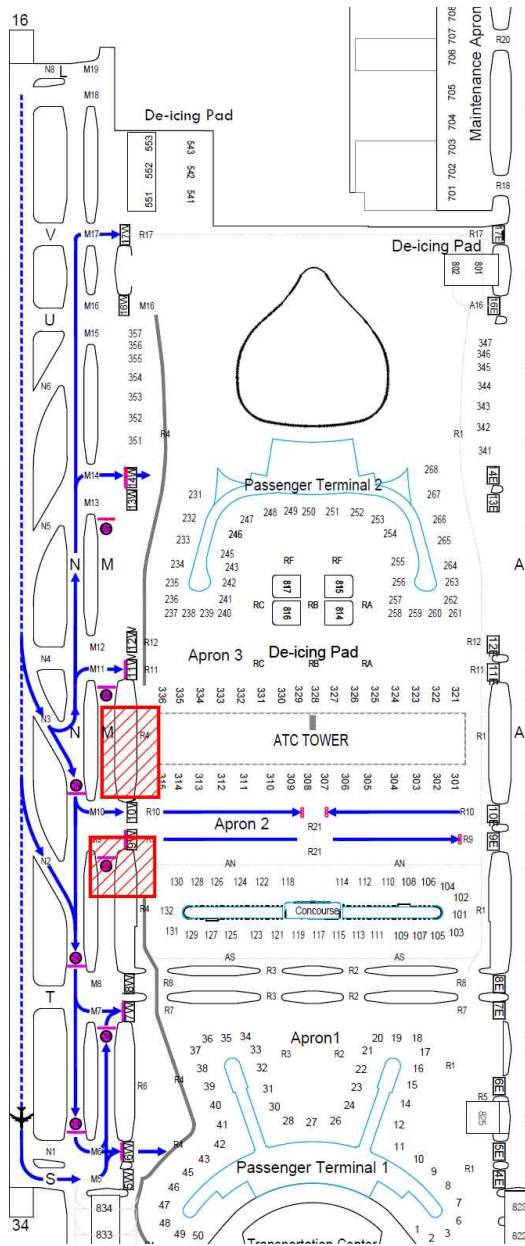

Departure for RWY 16

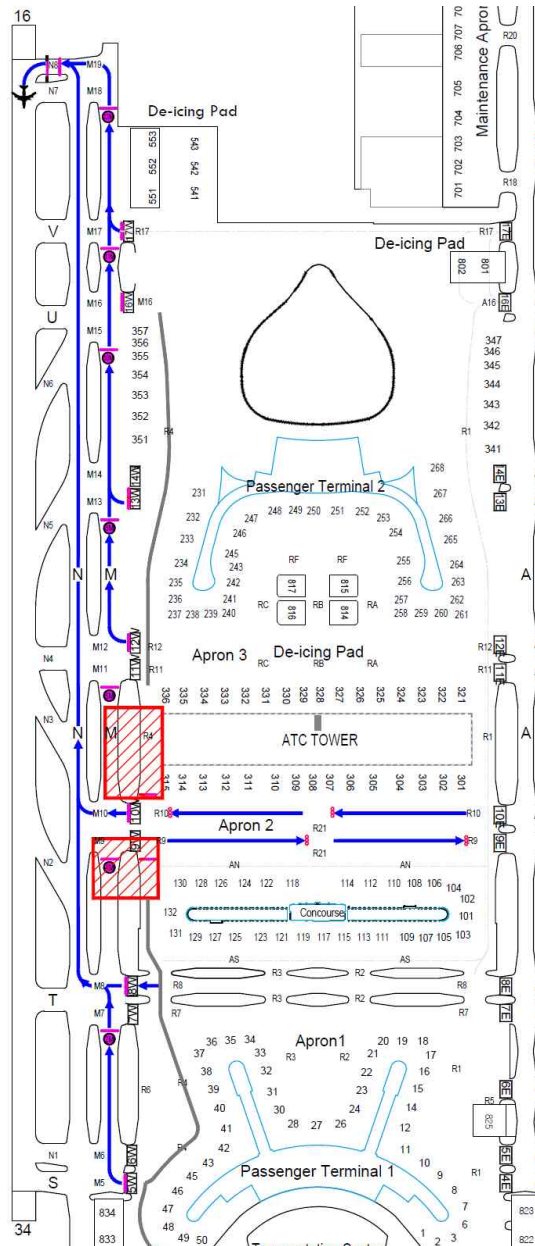

* Aircraft will take a detour on M8

Temporary Taxi Routes

Arrival for RWY 34

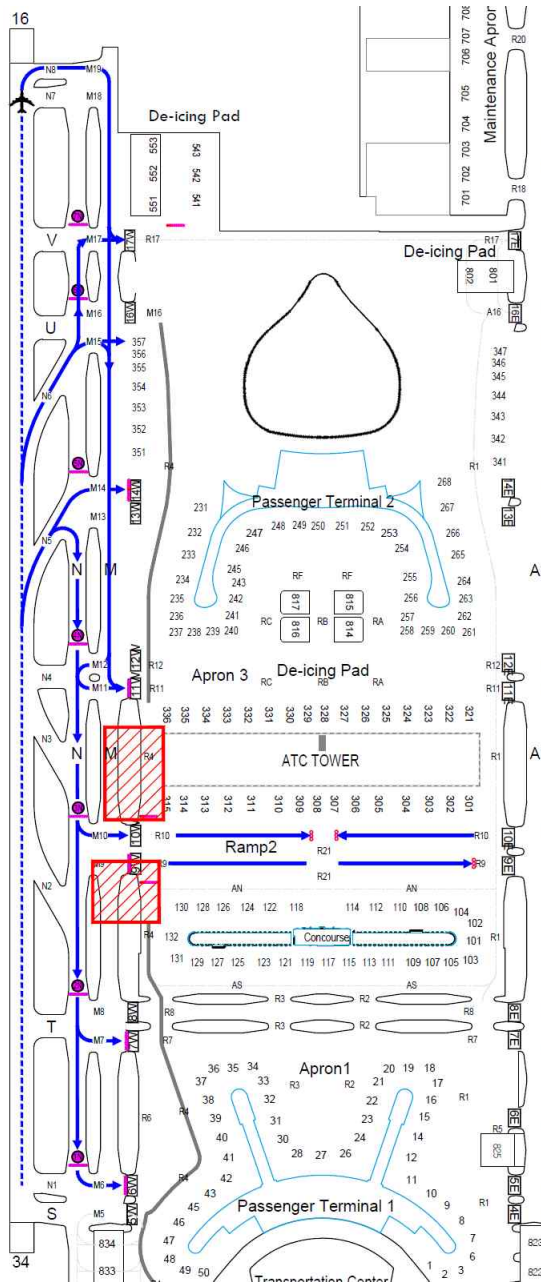

Departure for RWY 34

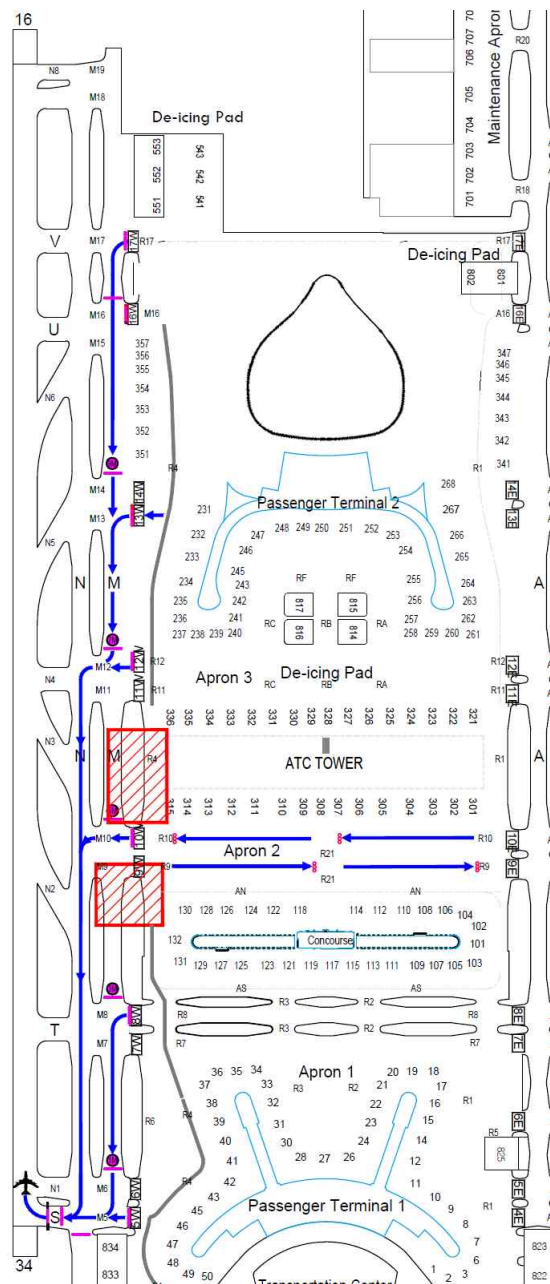

* Aircraft will take a detour on M12